

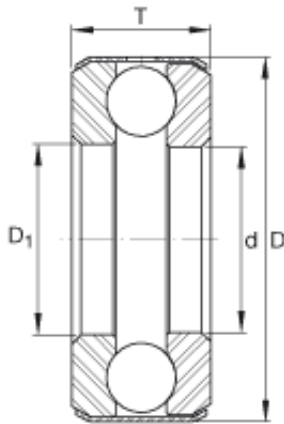

BEARING INDIA PRIVATE LTD.



B16 Bearing 2D drawings and 3D CAD models

GATES RACING TIMING BELT HONDA CIVIC SI B16 B16A B16A2 1.6L DOHC VTEC - T227RB

Bearing No. B16

Size	36.513x62.71x19.05 mm
Bore Diameter	36,513 mm
Outer Diameter	62,71 mm
Width	19,05 mm
d	1 7/16 inch
d	36,513 mm
D	2,469 inch
D	62,71 mm
T	0,75 inch
T	19,05 mm
D ₁	1,469 inch
m	0,512 lbs / Weight
m	0,232 kg / Weight
C _a	9500 lbf / Dynamic load rating (axial)
C _a	42300 N / Dynamic load rating (axial)
C _{0a}	20100 lbf / Static load rating (axial)
C _{0a}	89000 N / Static load rating (axial)
Category	Thrust Ball Bearing
Inventory	0.0
Manufacturer Name	SCHAEFFLER GROUP
Minimum Buy Quantity	N/A
Weight / Kilogram	0.23



BEARING INDIA PRIVATE LTD.

Product Group	B00308
Rolling Element	Ball Bearing
Thrust Bearing	Yes
Single or Double Direction	Single Direction
Banded	Yes
Precision Class	ABEC 1 ISO P0
Component Description	Roller Assembly Plus Raceways
Other Features	Single Row Deep Groove Medium Cross Section Grooved Race Non Separable Full Complement Standard Oil Hole in Band
Long Description	1-7/16" Bore 1; 1-15/32" Bore 2; 2-15/32" Outside Diameter; 3/4" Height; Ball Bearing; Single Direction; Banded; ABEC 1 ISO P0 Precision
Inch - Metric	Inch
Category	Thrust Ball Bearings
UNSPSC	31171507
Harmonized Tariff Code	8482.10.50.08
Noun	Bearing
Keyword String	Ball Thrust
Manufacturer URL	http://www.ina.com
Manufacturer Item Number	B16
Weight / LBS	0.512
Bore 2	1.469 Inch 37.313 Millimeter
Bore 1	1.438 Inch 36.525 Millimeter
Outside Diameter	2.469 Inch 62.713 Millimeter
Overall Height with Aligning Washer	0 Inch 0 Millimeter



BEARING INDIA PRIVATE LTD.

Height	0.75 Inch 19.05 Millimeter
--------	------------------------------